

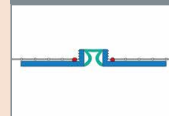

W50

**APU**<sup>®</sup>

PROFILES FOR COMPOUND HEAT INSULATION SYSTEMS

## Movement joint **DUO-TEX**

With 2 x 12.5 cm mesh

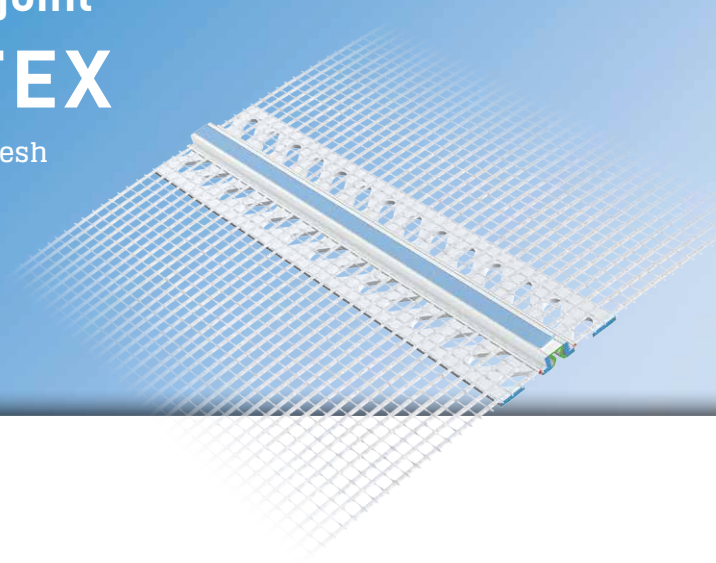

The **APU movement joint DUO-TEX** is used in compound heat insulation systems for forming vertical movement joints and in dry wall construction for compensating minor structural element movements.

The profile has two perforated plaster bars, welded to each of which is a mesh strip. Between the profiles there is a co-extruded, flexible TPE loop, which can absorb smaller structural element movements. It is covered with protective film to protect it during the plastering work. Thanks to the flexible lug, the profile can be used on flat surfaces and inner corners. The raised edge of the plaster take-up area is available in two different versions (3 mm and 6 mm plaster thickness). In the course of the work, the profile can additionally be fixed in the insulating material using the plug connectors provided (Z13). The area where pieces abut must be sealed off using a suitable sealant (e.g., PUR sealing strip, Butyl sealing strip, or similar). After the plastering work is completed and protective film is removed, a clean termination of the plaster is created.



W50

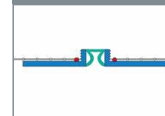

## Design

	ITEM NO.	LENGTH	PACKAGING UNIT	WEIGHT (per PU)
--	----------	--------	----------------	-----------------

### DUO-TEX expansion joint profile

W50

With 2 x 12.5 cm mesh

Plaster thickness 3 mm	<b>W50-2003</b>	2.0 m	25 bars = 50 m	7.1 kg
Plaster thickness 6 mm	<b>W50-2006</b>	2.0 m	25 bars = 50 m	8.1 kg

## Features

	DUO-TEX EXPANSION JOINT PROFILE
Material	<ul style="list-style-type: none"> <li>■ Rigid PVC manufactured under DIN-16941</li> <li>■ TPE manufactured under DIN-16941</li> </ul>
Mesh	<ul style="list-style-type: none"> <li>■ Min. 160 g/m<sup>2</sup> approved for compound heat insulation systems</li> <li>■ 2 x 12.5 cm wide – MW 4x4 mm</li> <li>■ Ultrasonic welded</li> </ul>
Accessories	<ul style="list-style-type: none"> <li>■ Z13-0000 Plug connectors (1 bag)</li> </ul>
Movement absorbed on surface area	<ul style="list-style-type: none"> <li>■ W50-2003 stretchable by c. 4 mm, compressible by c. 1-2 mm</li> <li>■ W50-2006 stretchable by c. 10-15 mm, compressible by c. 1-2 mm</li> </ul>
Movement absorbed in internal corner	<ul style="list-style-type: none"> <li>■ W50-2003 stretchable by c. 2 mm, compressible by c. 1 mm</li> <li>■ W50-2006 stretchable by c. 5-6 mm, compressible by c. 1-2 mm</li> </ul>

## Important information

Storage	Always store profiles laid down in a dry place.
Other applications	Any applications not clearly described in the documents may be implemented only after consultation with the plaster or ETICS manufacturer.

For information on materials, areas of use, tests and correct application, please refer to our 'General Advice and Information'



W50



## Details

W50-03

Mesh 4x4 mm  
125 mm wide

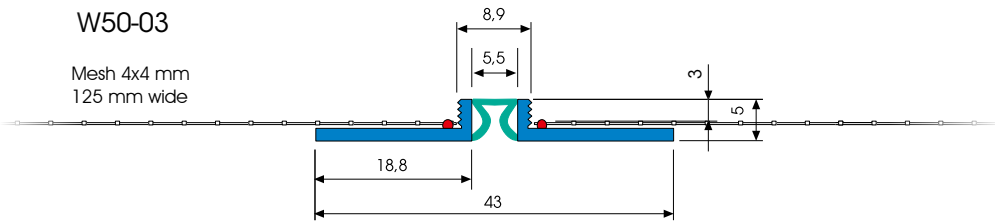

W50-06

Mesh 4x4 mm  
125 mm wide

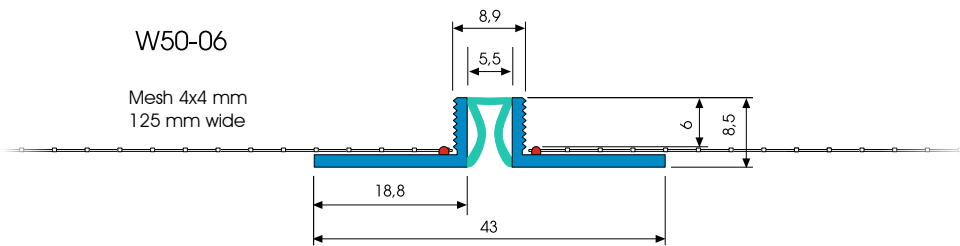

Sectional drawing in mm

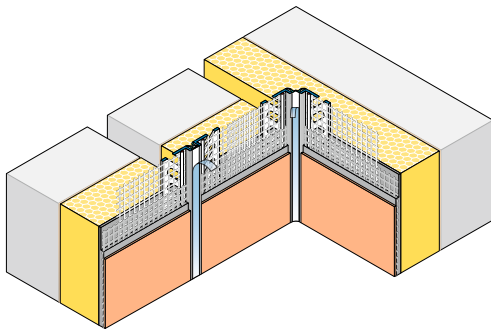

Application drawing