

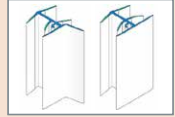

Z22



# APU<sup>®</sup>

PROFILES FOR COMPOUND HEAT INSULATION SYSTEMS

## Cover profile for extension joint

For corners and surfaces

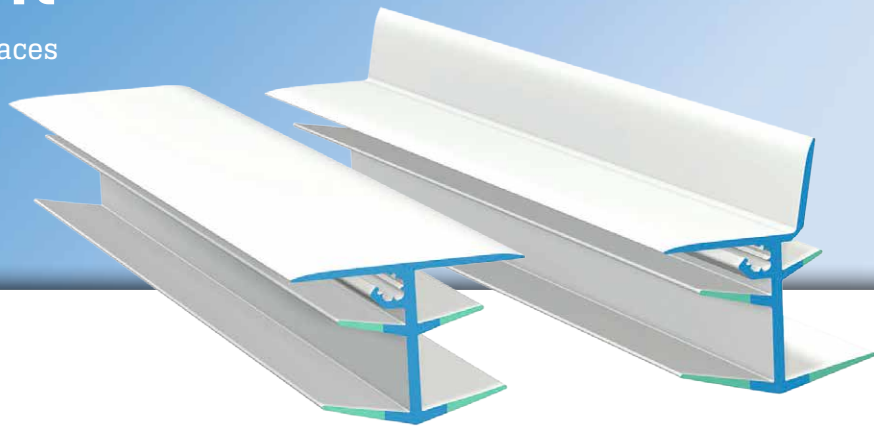

The **APU expansion joint cover profiles** Z22-E (for corners) and Z22-F (for flat surfaces) can be used to hide expansion joint profiles W51 and W52 from view. So that the covering profiles are held firm, a clearance of 20 - 25 mm must be adhered to for the insulation panel opening.

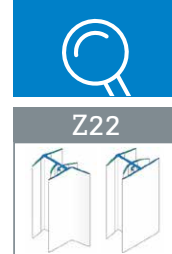

## Design

|  | ITEM NO. | LENGTH | PACKAGING UNIT | WEIGHT (per PU) |
|--|----------|--------|----------------|-----------------|
|--|----------|--------|----------------|-----------------|

### Cover profile for extension joint

| Z22            |            |       |                  |         |
|----------------|------------|-------|------------------|---------|
| ■ For corners  | Z22-E-2100 | 2.1 m | 25 bars = 52.5 m | 11.0 kg |
| ■ For surfaces | Z22-F-2100 | 2.1 m | 25 bars = 52.5 m | 9.7 kg  |

## Features

|              | COVER PROFILE FOR EXTENSION JOINT  |  |
|--------------|--|--|
| Material     | <ul style="list-style-type: none"> <li>■ Rigid PVC manufactured under DIN-16941</li> <li>■ TPE manufactured under DIN-16941</li> </ul> |  |
| Suitable for | W51  | DUO-TEX-K expansion joint profile for corners  |
|              | W52  | DUO-TEX-K expansion joint profile for surfaces |

## Important information

|                    |  |
|--------------------|--|
| Storage            | Always store profiles laid down in a dry place.  |
| Other applications | Any applications not clearly described in the documents may be implemented only after consultation with the plaster or ETICS manufacturer. |
| Recommendation     | We recommend sticking the expansion joint cover profile Z22 on one side using appropriate PU adhesive/sealant.                             |

For information on materials, areas of use, tests and correct application, please refer to our 'General Advice and Information'

## Details

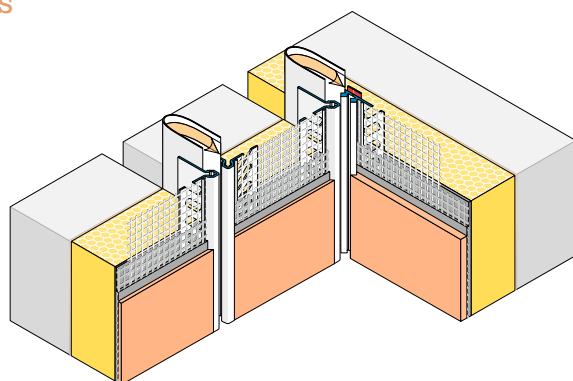

Application drawing